



For brick wall, sand block wall & AAC block wall:
The usage of UPVC door frame liner, insert along the door frame side as a joining line with plastering /render surface.

For shear wall:
The usage of UPVC door frame liner (model DF5/F6), insert along the door frame side as a joining line with skim surface.

Comparison on plastering direct join with door frame fringe, or steel door frame with ready groove, and usage of UPVC Door Frame Liner:

Subject 1: The Effect of Work Method

Direct Joining The Plastering Surface With Door Frame	Using the steel door frame with curve liner	UPVC Door Frame Liner
<p>When door frame installed at the predetermine location and followed by brick laying work. All the support prop used for staging the installed door frame and the frame bottom support can be occasionally displaced due to accidental collision with workers and building material at the door frame.</p> <p>When the plastering work on the surface accomplished until the door frame joining position:</p> <ul style="list-style-type: none"> - From the visual observation it is noticed that the wall plastering surface is not flatten and not parallel with door frame joining area. Regret for the above issue, it require hacking and touch up work to be done. <p>It caused the extra expenditure and the work progress is slow down.</p> <p>Workers only realize the joining issue and unevenness of the plastering surface with door frame.</p>	<p>Door Frame curve shape get altered from the original shape due to impact of transportation, handling and unloading at site. This deviation is not visually detectable.</p> <p>When door frame installed at the predetermine location and followed by brick laying work. All the support prop used for staging the installed door frame and the frame bottom support can be occasionally displaced due to accidental collision with workers and building material at the door frame.</p> <p>When the plastering work on the surface accomplished until the door frame joining position:</p> <ul style="list-style-type: none"> - From the visual observation it is noticed that the wall plastering surface is not flatten and not parallel with door frame curve joining area, it require hacking, repair the curve and touch up plastering work. <p>It caused the extra expenditure and the work progress is slow down.</p> <p>Workers only realize the joining issue and unevenness of the plastering surface with door frame with curve at later stage.</p>	<p>Upvc Door Fame liner Tip installation followed the door frame edge as a guide for the whole surface surrounding of the door frame.</p> <p>Even though door frame installed at the predetermine location and followed by brick laying work. All the support prop used for staging the installed door frame and the frame bottom support can be occasionally displaced due to accidental collision with workers and building material at the door frame.</p> <p>When the plastering work on the surface accomplished until the door frame joining position:</p> <p>With the UPVC door frame liner usage the plaster surface level unevenness or door frame minor displacement ,these defects are not easily visually detectable. If there is a minor crack line formed between door frame and concrete wall due to vibration/movement after few years, it is difficult to notice from visual observation.(its hidden by the liner)</p> <p>The above method provided by our Door Frame liner will able control the costing and speed up the work progress.</p>

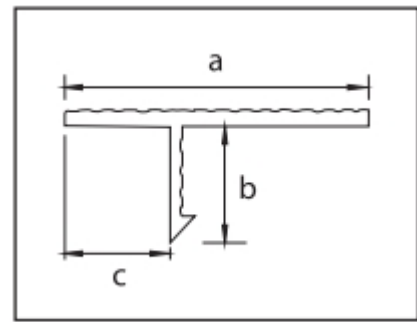
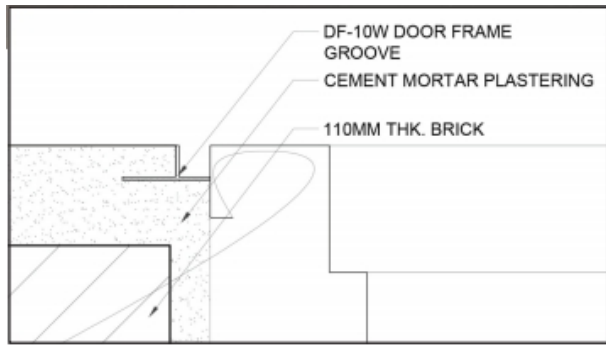

Model	*Dimension (mm)			Length (m)	Packing (pcs)	Colour	Quality Standard
	a	b	c				
DF5W	23	5	5	2.2/2.5	100	White	Green
DF10W	28	10	10	2.2/2.5	100	White	Green
DF12W	30	12	15	2.2/2.5	80	White	Green
DF1212W	30	12	12	2.2/2.5	80	White	Green
DF15W	33	15	12	2.2/2.5	70	White	Green
R-DF5W	23	5	5	2.2/2.5	100	White	Premium
R-DF10W	28	10	10	2.2/2.5	100	White	Premium
R-DF12W	30	12	15	2.2/2.5	80	White	Premium
R-DF1212W	30	12	12	2.2/2.5	80	White	Premium
R-DF15W	33	15	12	2.2/2.5	70	White	Premium

Application Procedure:

1. UPVC door frame liner installed along surrounding of door frame edge between door frame and plastering/render/ skim-coat surface.
2. Apply a strip of mortar at surrounding door frame edge.
3. Install the "Door Frame Liner" on surrounding frame edge follow by the "door frame liner tip" to the same level with the door frame edge.
4. Fill the mortar at single row of holes at wing of "Door Frame Liner" in order to hold and set it correctly.