

## L-Shape Profile

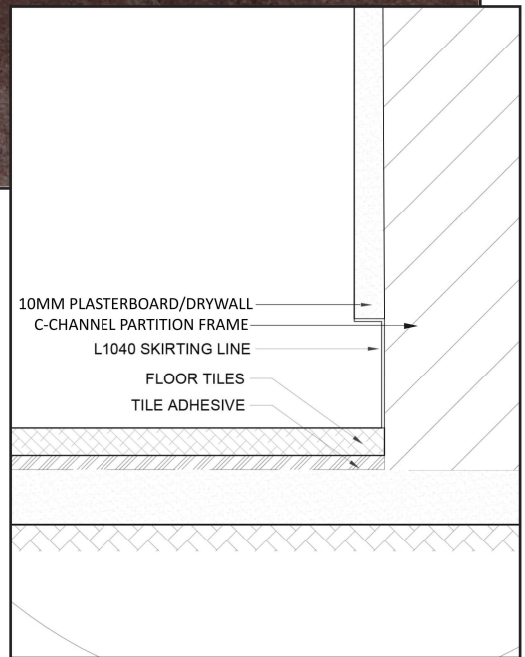

Model	*Dimension (mm)		Length (m)	Packing (pcs)	Colour	Quality
	a	b				
L1040	40	10	2.5	50	White	Green
R-L1040	40	10	2.5	50	White	Premium

\* The tolerance limit is ± 1mm

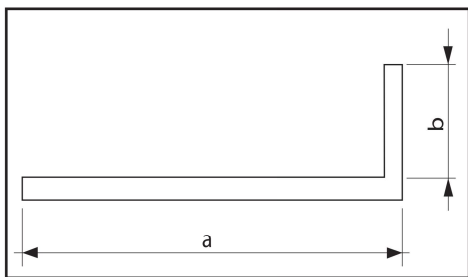

## A-Angle® uPVC Drywall Skirting Liner L-Shape Profile

### Product Description

- Designed for interior void groove spacing of partition wall skirting to ensure furniture attach perfectly to the wall without gapping compared to exterior skirting design.
- Protect plasterboard/ drywall against erosion damage from water/cleaning detergent etc.
- Excellent chemical resistance to most oils, alcohols, petrol and fats. Avoid contact with aromatic and chlorinated hydrocarbons, ketones, nitro compounds, esters with cause some swelling.
- Suitable to use below 60°C.

### Certification

- Trusted quality with SIRIM CERTIFICATION.
- Quality management with ISO CERTIFICATION.
- Comply with GREEN LABEL SINGAPORE STANDARD.

### Area of Applications

For surrounding partition wall skirting.

### Application Procedure

1. Fix the Upvc Drywall skirting liner to C-channel bottom using the power-nailer.
2. Install partition wall above the Upvc Drywall skirting liner.

### Storage

Stored vertically out of direct sunlight or extreme temperatures or put in flat if supported along entire length.

\*For further information or technical detail, kindly contact our sales representative.